

# 2012 AMM Exhibitor/Advertiser Reservation Form

- Exhibit Fee is **\$500** by December 31, 2011  
**\$700** by April 30, 2012 or  
**\$900** ON/After May 1, 2012
- Booth reservations are confirmed upon receipt of payment.
- Booths in the Resource Hall are 8' deep x 10' wide and include 2 chairs, one 8' skirted table, wastebasket & sign
- **Set-up times:** Monday, July 23, 1:00 pm - 5:00 pm
- **Show times:** Tuesday, July 24, 8:00 am - 5:00 pm  
Wednesday, July 25, 8:00 am - 1:00 pm
- **Tear-down times:** Wednesday, July 25, 1:00 pm - 3:00 pm
- Exhibitors receive **two complimentary registrations** - please fill out the **Exhibitor Registration Form** so that we may have a badge ready for your employees. **NOTE:** You may attend any of the events, including free activities, but please mark the form accordingly. You will be required to pay for activities for which there is an additional fee.
- Prices for additional equipment, electricity, internet, shipping, and storage will be mailed to you at a later date.
- **Select your 1st, 2nd and 3rd choice for a booth below.**  
Floor plan is subject to minor changes based on hotel needs.

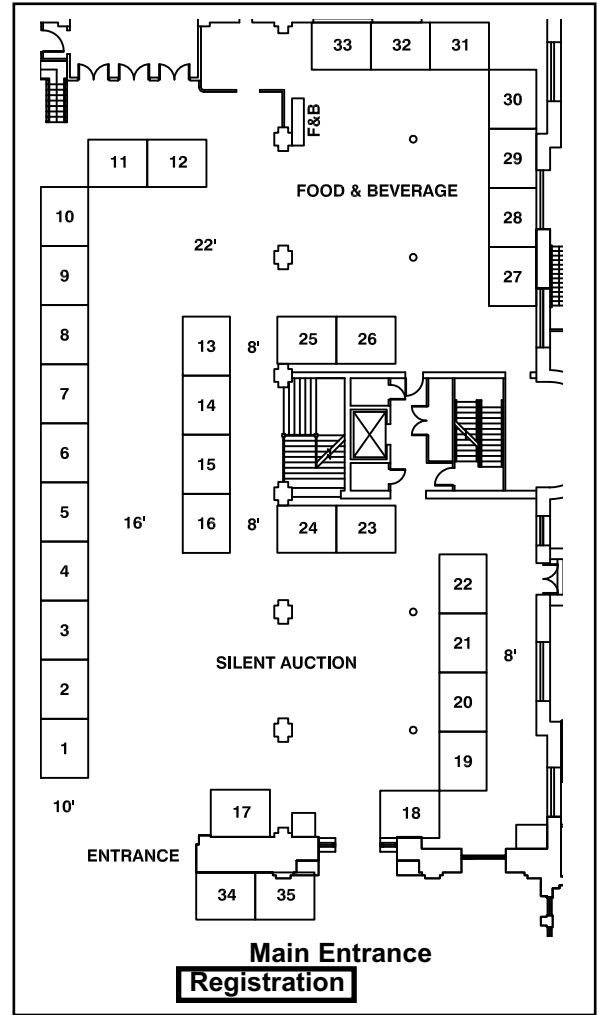

Choice #1 _____ Choice #2 _____ Choice #3 _____
---

Contact Name: \_\_\_\_\_

Title \_\_\_\_\_

Company \_\_\_\_\_

Address \_\_\_\_\_

City, State, Zip \_\_\_\_\_

Phone: \_\_\_\_\_ Fax: \_\_\_\_\_

Email \_\_\_\_\_

Signature \_\_\_\_\_

Credit Card # \_\_\_\_\_ Exp: \_\_\_\_\_

## FEES

### MEMBERSHIP

AMM \$ \_\_\_\_\_

**NOTE:** All exhibitors are required to become members of AMM.

### CONFERENCE

SPONSORSHIP \$ \_\_\_\_\_

EXHIBIT BOOTH \$ \_\_\_\_\_

TOTE INSERTS \$ \_\_\_\_\_

BROCHURE TABLE \$ \_\_\_\_\_

OTHER \$ \_\_\_\_\_

### PROGRAM ADS

PRELIMINARY \$ \_\_\_\_\_

FINAL \$ \_\_\_\_\_

**FEE TOTAL** \$ \_\_\_\_\_

**Mastercard or VISA only!**

*AMM also accepts check payments.*

**PLEASE LIST THE NAME AND TITLE OF THE TWO COMPLIMENTARY CONFERENCE ATTENDEES.  
ALSO, PLEASE SUBMIT THE EXHIBITOR REGISTRATION FORM FOR EACH EXHIBITOR.**